

# ***INSTALLATION INSTRUCTIONS***

Rev. 2

## MODEL NO. 59771

**APPLICATION:** 2008-Current Honda Accord (sedan & coupe)

### ***WARNING***

Although this hitch is designed to safely tow its rated load, we recommend that you consult your vehicle owner's manual for possible manufacturer's recommendations or limitations. Always follow the manufacturer's installation instructions and always install on the specified vehicle. Before installing hitch, check that the attachment points are in good condition.

Failure to follow these guidelines will void warranty. Any modifications to this hitch will void warranty.

### ***HITCH CAPACITY***

**2000 LBS. MAXIMUM TRAILER WEIGHT**  
**200 LBS. MAXIMUM TONGUE WEIGHT**

Trailer brakes are recommended for towing loads in excess of 1500 lbs.

**WARNING:** If this hitch is used with any auxiliary load carrying product, such as bicycle or cargo carriers, the loaded weight must not exceed 200 lbs. including the weight of the carrier. The loaded carrier weight with the extended leverage may damage hitch and/or attachment points on vehicle.

### ***COMPLETE PARTS LIST***

Part	Description	Quantity
1.	Receiver Assembly	(1)
2.	1579-01 1/2-13 x 1-1/2 Cge Bolt	(4)
3.	1935-03 Reinforcement Spacer	(2)
4.	1828-03 1/2-13 Hex flange Serrated Locknut	(4)
5.	1826-04 1/2" Square Hole Plate	(2)
6.	1021-01 M10 x 45 x 24 x 20 U-Bolt	(1)

Part	Description	Quantity
7.	1879-03 7/16" Lockwasher	(2)
8.	2432-03 M10 x 1.50mm Hex Nut	(2)
9.	2688-01 Ball Mount	(1)
10.	1083-04 Hitch Pin	(1)
11.	1335-03 Hair Pin	(1)
12.	4751-04 Receiver Cover	(1)

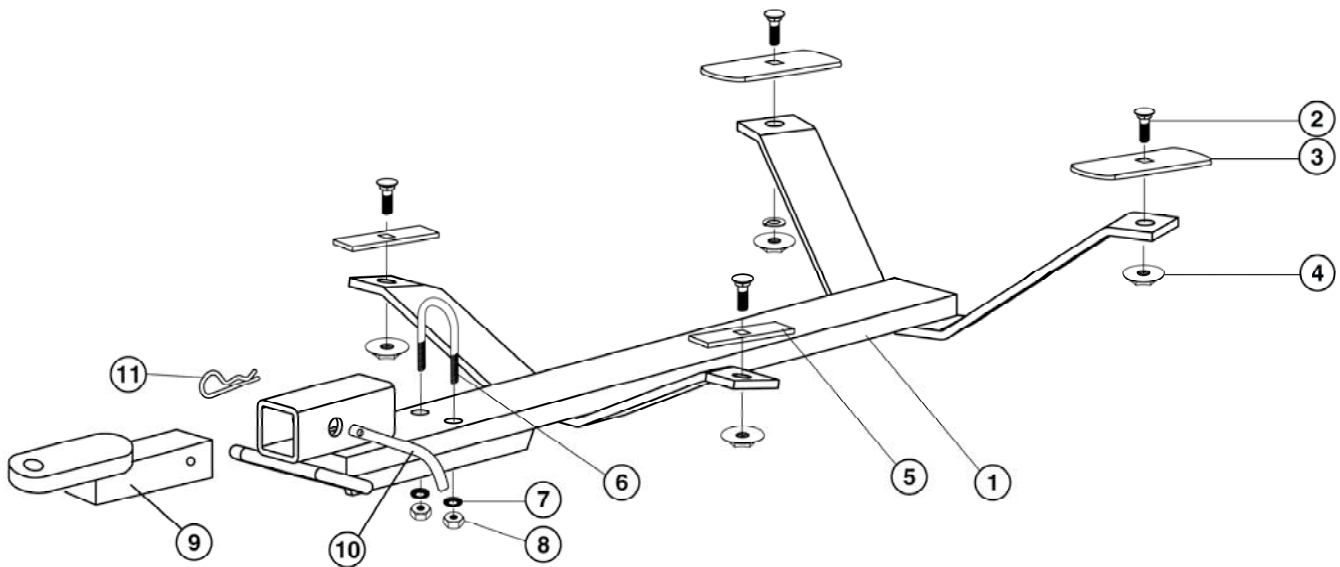

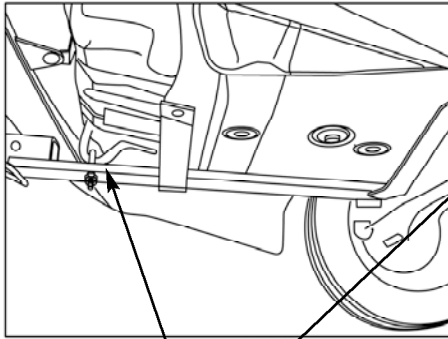

**MOUNT HITCH TO TOW LOOP  
WITH U-BOLT AND HEX NUT**

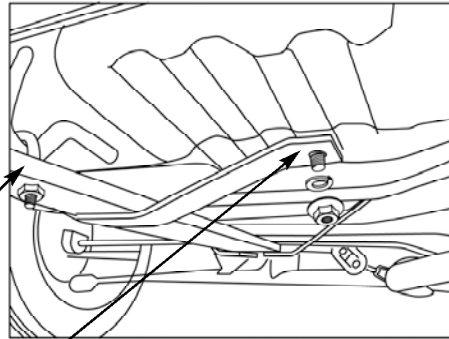

**MARK HOLES ON UNDERBODY.  
THESE HOLES SHOULD BE ON  
RAISED SURFACE AND NOT IN  
THE INDENTS**

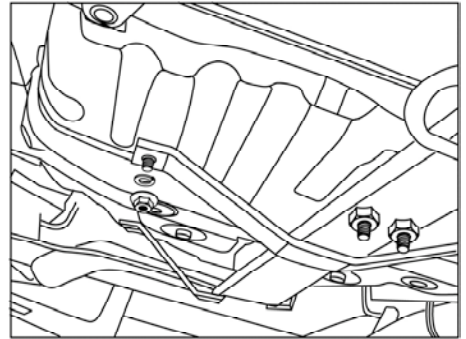

**DRILL 5/8" HOLES**

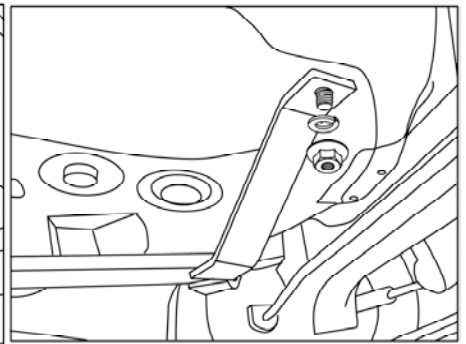
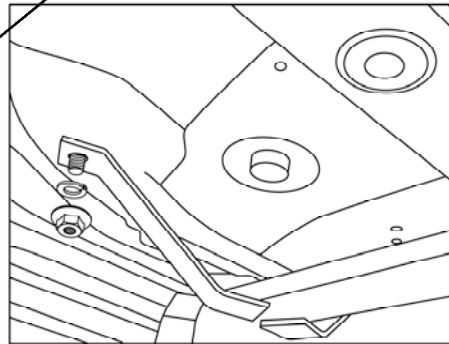

1. Remove the spare tire from its trunkwell storage location. Drilling for hitch installation will be done in this area. Check lower edge of bumper. If your vehicle is equipped with a small trim strip, attached to the lower lip of the bumper, it must be removed to install hitch.
2. Position the hitch assembly #1 against the bottom center section of the trunk floor/tire well. Hitch should be centered over the tie down loop.
3. Loosely attach the hitch assembly to the tie down loop with the M10 x 45 x 24 x 20 U-Bolt #6, M10 x 1.50mm Hex Nut #8 and 1879-03 7/16" Lockwasher #7. Leave attaching nuts loose until hitch is completely installed.
4. Center the hitch assembly on the tire well and drill four 1/2" attachment holes up through trunk floor using the holes in hitch assembly yokes as guides. On some vehicles the tailpipes may need to be moved slightly to gain a clear access to trunk floor drilling location.
5. From inside the trunk compartment, place a Reinforcement Spacer #3 over the forward 2 drilled holes in trunk floor and 1/2" Square Hole Plate #5 over the rear 2 drilled holes. Drop a 1/2-13 x 1-1/2 Cge Bolt #2 through each reinforcement plates and holes in trunk floor and yokes on hitch assembly. Bolt hitch assembly securely in place with 1/2-13 Hex flange Serrated Locknut #6.
6. Tighten the 1/2" bolts to 75 ft. lbs. torque and U-Bolt Nuts to 53 ft. lbs. torque. Failure to tighten bolts as described may result in fastener loss or failure.
7. Slide ball mount #9 into hitch assembly receiver and secure with hitch pin #10 and hair pin #11.

**WARNING:** Use only the ball mount supplied with this hitch. Use this hitch only as a weight carrying hitch.

**DO NOT** use with any type of weight distributing hitch.

**WARNING:** Be sure to check the hitch pin and hair pin for positive locking placement before towing a trailer.

**NOTE:** When hitch is not in use, remove ball mount from receiver and place the receiver cover into receiver opening.

**NOTE:** Some states require a clear view of license plates. Remove trailer ball and/or ball mount when not in use if it restricts view.

For information regarding this product, or our warranty, contact your dealer or write to:  
"CUSTOMER SERVICE MANAGER" P.O. Box 850, Lodi, CA 95241

This product complies with regulation V-5, C.S.A Standard D-264 and safety requirements for connecting devices  
and towing systems of the State of New York

**59771**